



- FR** Thermostat Programmable radio
- EN** Wireless programmable thermostat
- DE** Programmierbarer Funkthermostat
- IT** Termostato radio programmabile

Contents

1 - Installation	34
2 - Description	36
3 - Wireless association	37
4 - Configuration	38
5 - Setting the clock	45
6 - Setting the temperatures (set-points)	47
7 - Programming	49
8 - AUTO mode	50
9 - 'Party' mode	51
10 - Absence mode	52
11 - External exception	53
12 - Anticipation	53
13 - Information button	54
14 - Locking down settings	55
15 - Off mode	55
16 - Return to initial settings	57
17 - Deleting wireless associations	58
18 - Changing batteries	59
19 - Help	59
20 - Technical characteristics	60

1 - Installation

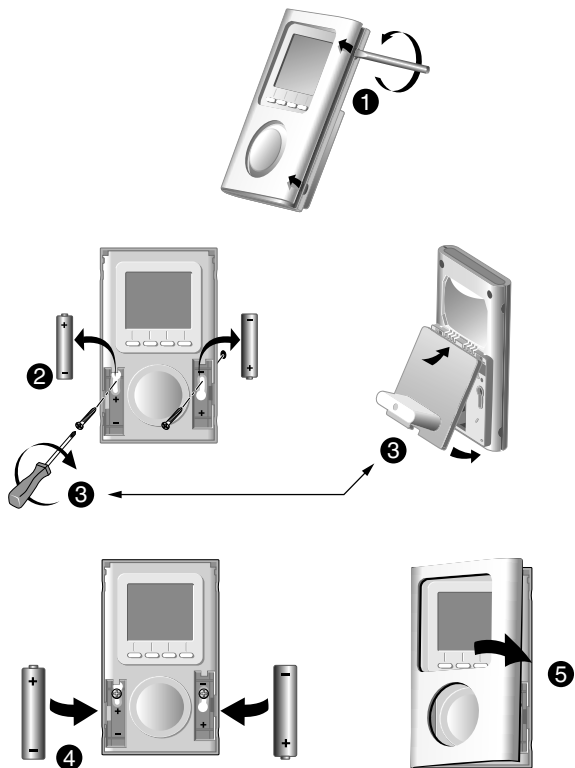

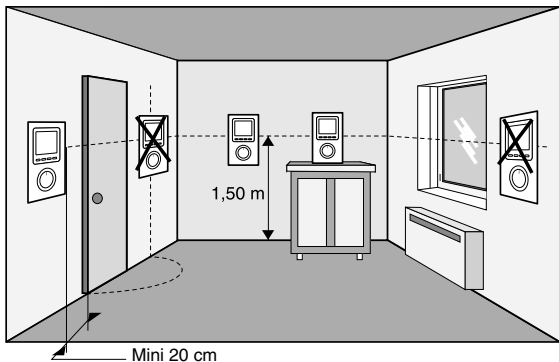

Place the thermostat:

- in the main room (e.g. living/dining room) or in the middle of your home,
- wall-mounted or placed on a shelf or a piece of accessible furniture at a height of 1.50 m,
- away from heat sources (fireplaces, direct sunlight) and draughts (windows, doors),

IMPORTANT: Do not install the thermostat on a wall in contact with the outside or with an unheated room (e.g. garage, etc.)

2 - Description

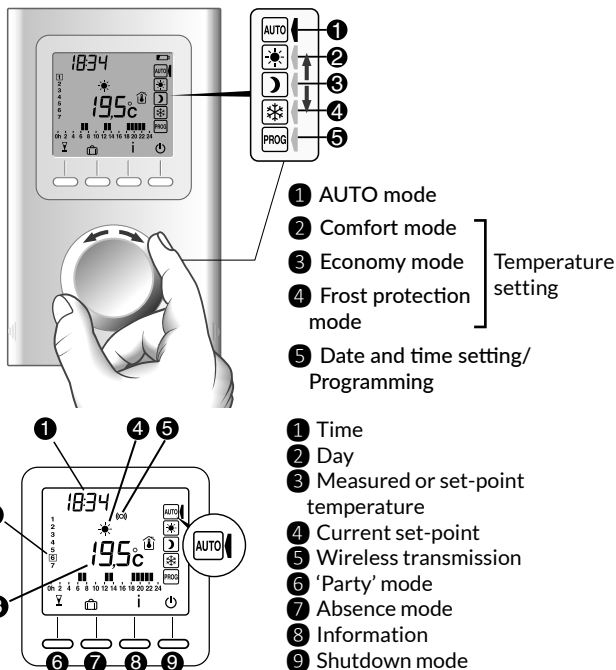

Standby mode:

When left idle for a given period of time, the product switches to standby. To activate the product, press any button or turn the selector knob.

3 - Wireless association

EN

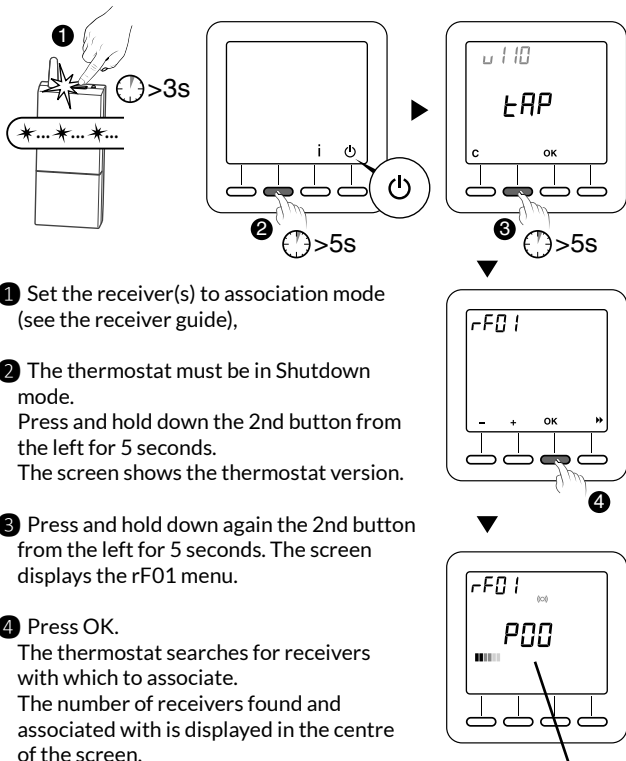

- 1 Set the receiver(s) to association mode (see the receiver guide),
- 2 The thermostat must be in Shutdown mode.
Press and hold down the 2nd button from the left for 5 seconds.
The screen shows the thermostat version.
- 3 Press and hold down again the 2nd button from the left for 5 seconds. The screen displays the rF01 menu.
- 4 Press OK.
The thermostat searches for receivers with which to associate.
The number of receivers found and associated with is displayed in the centre of the screen.

Number of receivers

4 - Configuration

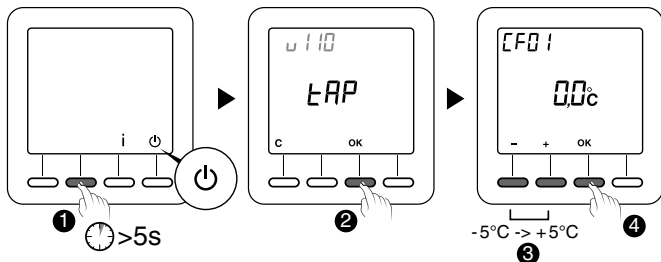

The thermostat must be in shutdown mode.

- 1** Press and hold down the 2nd button from the left for 5 seconds.
The screen displays the thermostat version.
- 2** Press **OK**.
The screen displays the CF01 menu.
- 3** Make your selection or setting by **+** and **-**.
Press **OK** to validate and go to the next setting.

To exit the mode, turn the selector knob

Comment: the greyed-out sections of the tables correspond to default values

CF01 - Correcting the temperature measured

Setting from $-5^{\circ}C$ to $+5^{\circ}C$.

Example: if the temperature displayed by the unit is $19^{\circ}C$ and the actual temperature (thermometer) is $20^{\circ}C$, set $+1^{\circ}C$.

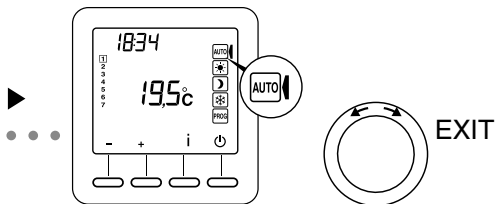

CF05 - Temperature displayed in AUTO mode

0	Temperature set-point
1	Measured temperature 

CF04 - Control type



0	PI control I(Proportional Integral)
1	All or nothing control

CF05 - Energy saving mode

0	Display turns off after 10-seconds if not pressed
1	Display turns off between midnight and 5:00
2	Display always on

4- Configuration

CF06 - Display ON/OFF button in standby mode

0	 symbol not displayed in standby mode
1	 symbol displayed in standby mode

CF07 - Backlighting

0	Deactivated
1	Enabled (off after timeout)

CF08 - Open door/window detection function

0	Deactivated
1	Activated

If an open door/window detector (e.g. window) is associated with the receiver, opening a window will switch the heating to Frost Protection.

CF09 - Presence detection function

0	Deactivated
1	Activated

If a motion detector is associated with a receiver, an automatic temperature reduction will be made in the event of prolonged absence:

- 1h30min -> current set-point -1.5°C
- 3h30min -> current set-point -3.5°C
- 48h -> Frost protection set-point

CF10 - Max comfort set-point value

Setting from 22°C to 30°C.

Default value: 28°C

CF11 - Programming format

0	Programming in 1 hour steps
1	Programming in 1/2 hour steps

CF12 - Time display format

0	12h (AM/PM)
1	24h

4- Configuration

CF13 - Automatic summer/winter time switch

0	Deactivated
1	Activated

If CF13 = 0, setting the date will not be available.

CF15 - Symbol display

If CF08 = 1:

0	Symbol always fixed even if detection
1	Flashing symbol if detection

CF16 - Symbol display (heating request)

0	Symbol not displayed
1	Symbol displayed

CF17 - Symbol display

0	Symbol fixed if detection
1	Flashing symbol if detection

CF18 - Consumption display

0	Deactivated
1	Activated

If consumption display is activated, indicate the power of the heating elements

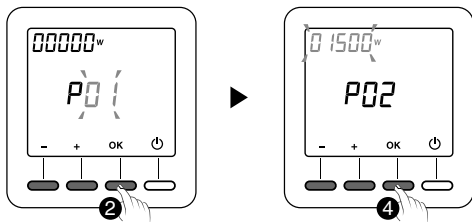

① Select the heating element

② Press OK to confirm.

③ Indicate its power in Watts.

④ Press OK to confirm.

CF28 - Anticipation function

The anticipation function enables the required Comfort temperature to be obtained at the programmed time.

0	Deactivated
1	Activated

Press + or - to activate or deactivate.

Press OK to confirm. Change to the CF29 menu.

4- Configuration

CF29 - Anticipation slope setting

The slope setting depends on the heating system.

It is set between 1°C/h to 6°C/h /(in steps of 0.1°C/h).

Default value: 3°C/h.

If the temperature is reached too early, reduce the value.

If the temperature is reached too late, increase the value.

Press + or - to set.

Press OK to confirm. Switch to the CF30 menu.

CF30 - Display of room temperature in shutdown mode

0	Deactivated
1	Activated

Press + or - to activate or deactivate.

Press OK to validate and exit the mode.

CF31 - Setting range of the Economy set-point

0	Setting from 5°C to Comfort Set-point
1	Setting from 5°C to 19°C

Press + or - to activate or deactivate.

Press OK to validate and exit the mode.

5 - Setting the clock

EN

- 1 Turn the selector knob to PROG.

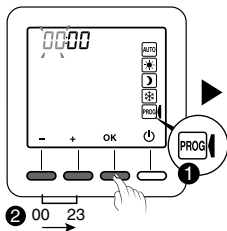

- 2 Set the time and press OK to confirm.

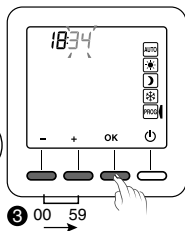

- 3 Set the minutes and press OK to confirm.

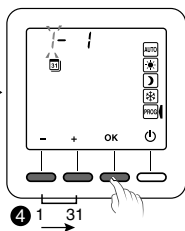

- 4 Set the day and press OK to confirm.

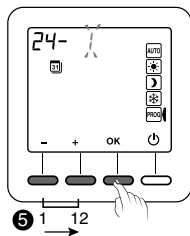

- 5 Set the month and press OK to confirm.

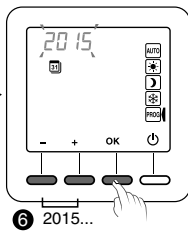

- 6 Set the year and press OK to confirm.

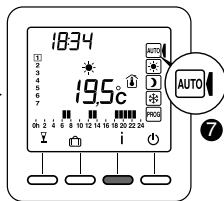

- 7 Turn the selector knob to AUTO to exit the mode

Setting the date can be made not available (see configuration CF13).

6 - Setting the temperatures (set-points)

If you remain in one of these modes, the thermostat will always operate according to this setting (no programming).

6.1 Setting the Comfort set-point

- 1 Turn the selector knob to ☀.
- 2 Set the Comfort temperature (from 5°C to Max comfort).
CF10 configuration
- 3 Press OK to confirm.

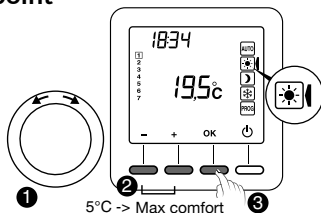

6.2 Setting the Economy set-point

- 1 Turn the selector knob to ☾.
- 2 Set the Economy temperature (from 5°C to 19°C or Comfort Set-point, see CF31 configuration menu).
- 3 Press OK to confirm.

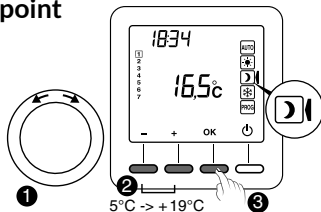

6.3 Setting the Frost Protection set-point

- 1 Turn the selector knob to ❄.
- 2 Set the Frost Protection temperature (from 5°C to 10°C).
- 3 Press OK to confirm.

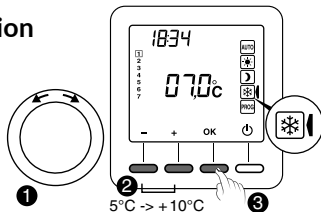

6.4 Behavioural indicator

When setting set-points, depending on the thermostat model, the screen colour changes or an indicator is displayed according to the temperature selected.

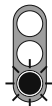
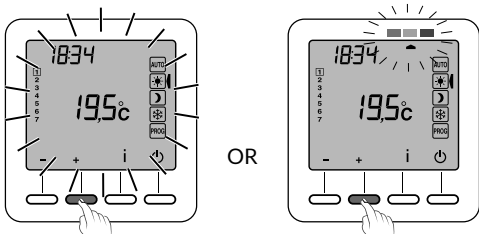

Green Up to 19°C (Low consumption)



Orange from 19.5°C to 24°C (Average consumption)



Red from 24.5°C to Max comfort. (High consumption)

To benefit from this function, depending on the thermostat model, activate the backlighting function.

7 - Programming

❶ Turn the selector knob to **PROG.**

On activating, the program for each day is a comfort period from 6:00am to 11:00pm.

You can create different Economy and Comfort periods using the ☀️ and 🌙 buttons.

Example: Comfort from 6.00am to 8.00am and 5.00pm to 11.00pm.

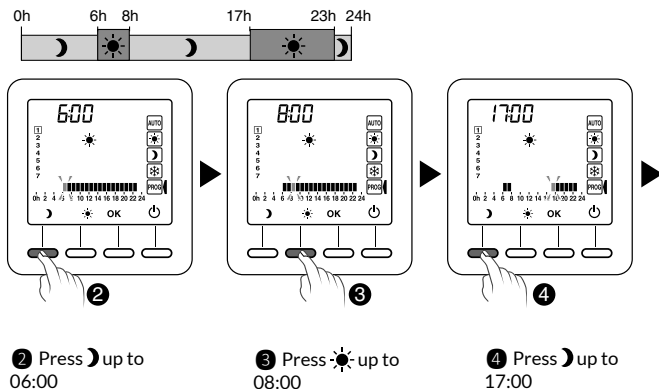

Programming can be made in 1 hour or 1/2 hour steps (CF11 configuration menu).

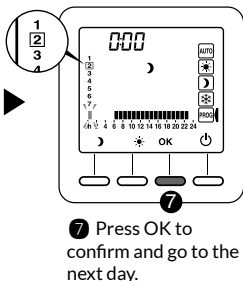
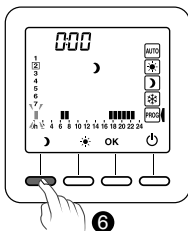
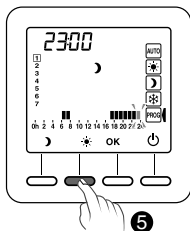
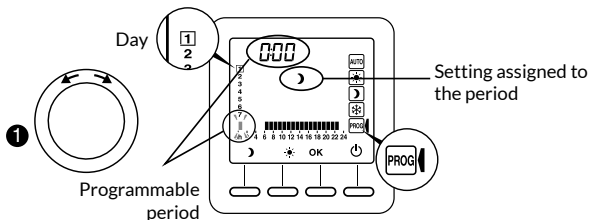

7 Pressing OK for 3 seconds confirms and recopies the programme to the next day (COPY function).

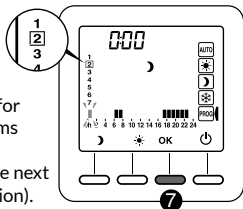





Repeat for each day of the week.

8 - AUTO mode

In AUTO mode, the thermostat follows the program of the day.

The  symbol indicates a heating request (CF16 configuration).

The automatic program may be suspended momentarily by:

- a 'Party Mode' exception (),
- an Absence mode (),
- an open window detection ( symbol flashing), if the function is activated (CF08 configuration). The heating will then switch to Frost Protection mode.
- an absence detection ( symbol off), if the function is activated (CF09 configuration). The heating will then switch to 'lower':
 - Absence 1h30 -> Current set-point -1.5°C
 - Absence 3h30 -> Current set-point -3.5°C
 - Absence 48h -> Frost protection set-point

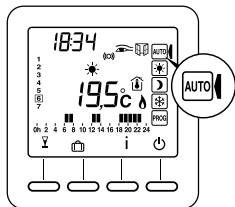



 : Heating request

 : Party mode

 : Absence mode

 : Measured temperature

 : Outside temperature

 : Open door/window detection

 : Presence detection active

 : External exception

 : Spent battery

 : Wireless transmission

9 - 'Party' mode

EN

'Party' mode temporarily suspends the automatic programme by applying a selected temperature set-point for a programmed period (30 minutes to 12 hours).

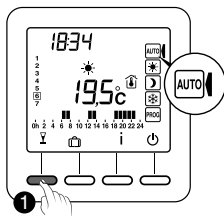

① From **AUTO** mode, press the  button.

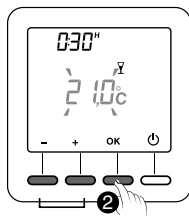

5°C-> Max comfort

② Set the desired temperature. Press OK to confirm.

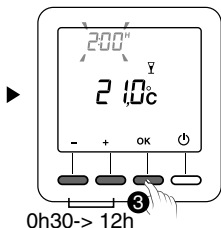

0h30-> 12h

③ Set the desired period. Press OK to confirm.

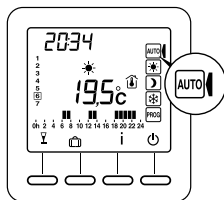



④ Countdown starts. Back to **AUTO** mode and its settings at the end of the countdown or press on **C**.

10 - Absence mode

This mode protects your home from frost if you are absent for several days.

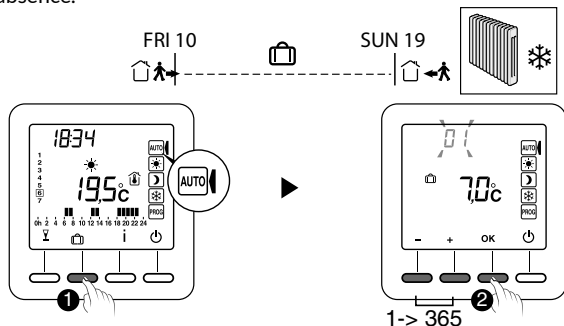
Example: Away on Friday 10 - Back on Sunday 19, programme 9 days of absence.



1 Turn the selector knob to **AUTO** and press .

2 Set the number of days of absence. Press OK to confirm.

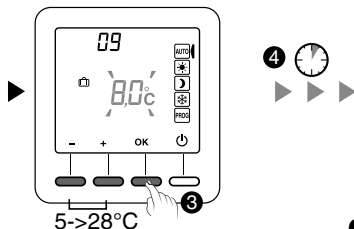

3 Set the absence temperature. Press OK to confirm.

4 Countdown starts. Back to **AUTO** mode and its settings at the end of the countdown or press on **C**.

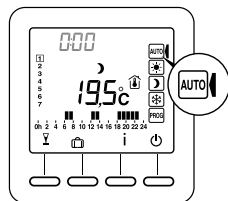

11 - External exception

The external exception suspends automatic operation of the thermostat via another wireless transmitter permitting this function.

EN

In the event of an external exception, the  symbol and the new exception value are displayed.

The thermostat followings the settings requested by the external transmitter.

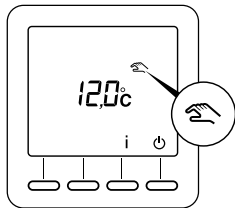

When there is an external exception, if the  symbol is not displayed on the thermostat screen, press on the i button or turn the selector knob to refresh the display.

12 - Anticipation

You have programmed your Comfort and Economy periods.

Anticipation (configuration menus CF28 and CF29) enables you to obtain the required Comfort temperature directly at the programmed time.

Example: you have programmed Comfort for 6pm, but anticipation function starts to raise the temperature beforehand (e.g. 4.30pm).

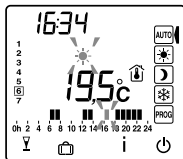

In AUTO mode, the current anticipation is shown by the  symbol flashing.

13 - Information button

The information button (i) shows the following information:

- measured temperature or current temperature set-point (according to configuration),
- outdoor temperature (if the receiver is associated with an outdoor sensor),
- total consumption of the associated heating elements (CF18 configuration).

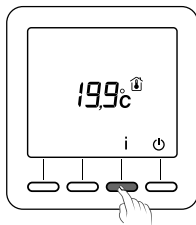

Successively press the i button to display this information.

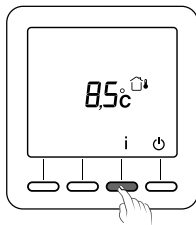

To reset the consumption indicator to zero, press the C button for 3 seconds.

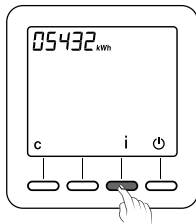

14 - Locking down settings

From the AUTO, ☀, ☾, ❄ modes.

Press and hold the 'i' button for 5 seconds.

The 🔒 symbol appears.

In locked mode, only the On / Off (⏻) and Information (i) buttons are available.

To unlock, press and hold the i button for 5 seconds.

The 🔒 symbol disappears.

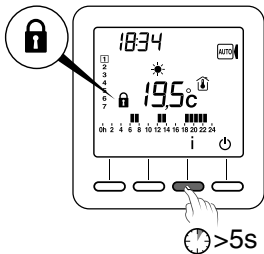

15 - Off mode

Press ⏻.

The thermostat emits a series of 3 beeps.

In this mode, heating is shut down.

To exit from shutdown mode, press the ⏻ button again.

The thermostat beeps.

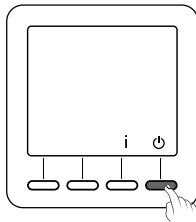

In this mode, heating is shut down.
Only the i button is available.

16 - Return to initial settings

16.1 Automatic reset of initial settings

From the Shutdown mode (⏻).

❶ Press and hold the left button and the **i** button for 10 seconds until 'Init' is displayed.

❷ Press and hold the OK button for 3 seconds.

The word 'Init' flashes.

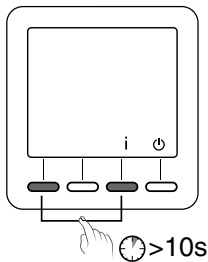

List of initialised settings:

- Temperature set-points
(Comfort 19°C, Economy 15.5°C,
Frost Protection 7°C),
- Open door/window detection function
(CF08=1),
- Presence detection function
(CF09=0),

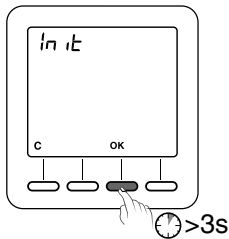

16.2 Initialisation of all settings

This mode resets all the configuration settings, set-points, and programming. Only the date and time are kept.

From the Shutdown mode (⏻).

1 Press the left button and the **i** button simultaneously for 20 seconds. After 10 seconds, the screen displays 'Init', press and hold until 'ALL' is displayed.

2 Press and hold the OK button for 3 seconds. The words 'Init' and 'ALL' flash. The values and settings are initialised.

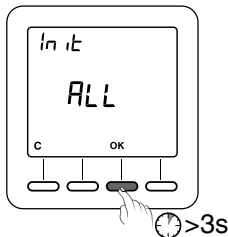
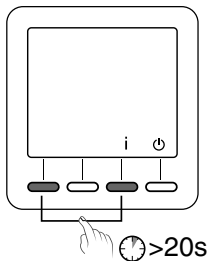

17 - Deleting wireless associations

- 1 The thermostat must be in Shutdown mode.

Press and hold down the 2nd button from the left for 5 seconds.

The screen displays the thermostat version.

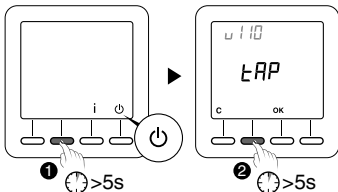

- 2 Press and hold down again the 2nd button from the left for 5 seconds.

The screen displays the rF01 menu.

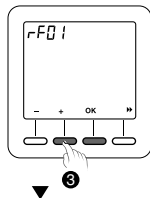

- 3 Press + to display rF03, then press OK.

The number of associated receivers is displayed in the centre of the screen.

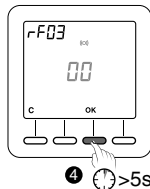

- 4 Press and hold OK for 5 seconds.

The thermostat deletes its wireless associations until it displays '00'.

To exit the mode, press on **C**, then on **>>**.

If the display does not return to 00, this means that some receivers are not responding. You can remove the association with a non-responding receiver by repeating the step described above.

At step 3, press once more on + to display rF04 and press OK to go to the next step 4.

18 - Changing batteries

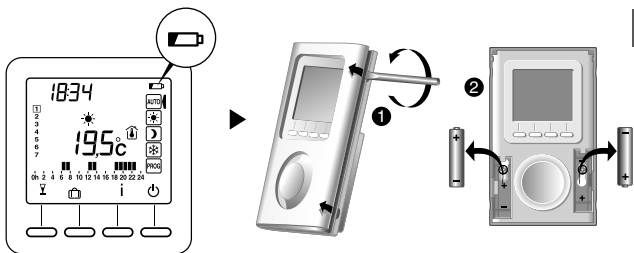

EN

When the symbol is displayed on the screen, you have about 3 months to change the batteries (see technical characteristics).

19 - Help

- The screen displays the symbol.
The batteries are spent. Replace the batteries
- A receiver does not receive the information from the thermostat.
The wireless range may be insufficient.
 - 1) Disconnect all your receivers, except the one not receiving.
 - 2) The thermostat must be in Shutdown mode.
 - 3) Press and hold down the 2nd button from the left for 5 seconds.
The screen displays the thermostat version.
 - 4) Press and hold down again the 2nd button from the left for 5 seconds. The screen displays the rF01 menu.
 - 5) Press + to display rF02.
The screen displays a figure from 0 to 4 (4 being the maximum range). If the figure is too low, change your installation.

20 - Technical characteristics

- Power supply according to model:
 - 2 LR03 or AAA-type 1.5 V alkaline batteries (supplied), autonomy of 5 years of normal use (CF05=0),
 - 2 LR03 or AAA-type 1.5 Ah lithium batteries (supplied), autonomy of 10 years of normal use (CF05=0),
- Class III insulation
- X3D Transmission frequency: 868.7 MHz to 869.2 MHz
- Maximum wireless power < 10 mW
- Category 2 receiver
- Wireless remote control device
- Wireless range from 100 to 300 metres outside, varies depending on the associated equipment (the range can vary depending on the installation conditions and the electromagnetic environment)
- Dimensions: 81 x 135 x 22 mm
- Degree of protection: IP 30
- Wall mounting or base unit
- Installation in an environment with normal pollution levels
- Storage temperature: -10°C to +70°C
- Operating temperature: 0°C to +40°C

- ES** Las instrucciones están disponibles previa petición al servicio técnico.
- PL** Instrukcja jest dostępna na żądanie w naszym dziale technicznym.
- CZ** Návod je k dispozici na vyžádání u technického oddělení.
- SI** Na zahtevo lahko dobite navodila pri tehnični službi.



BDR THERMEA GROUP



2705296 Rev.01